

**CYPRESS CREEK YMCA, SECTION 2  
RESTRICTED RESERVE "A"  
FILM CODE NO. 624243 H.C.M.R.**

Rec: N 88°39'59" E - 1439.57'  
N 88°39'59" E - 1439.66'

**0.759 ACRES**  
Houston Northwest Baptist Church  
H.C.C.F. No. 05316536

Rec: N 89°59'47" E - 72.05'  
N 89°59'47" E - 72.19'  
Concrete  
Paving Lot - 156.49'  
N 00°09'45" W - 584.68' (total)

Rec: N 00°09'45" W - 584.68'

**MARANTHA ROAD**  
(aka CY CREEK ROAD - 60' R.O.W.)

**MANDOLIN DRIVE**  
(60' R.O.W.)

**CYPRESS FOREST, SECTION 2  
(UNRECORDED SUBDIVISION)**

Rec: N 00°08'13" W - 441.59'  
N 00°08'13" W - 441.59'

65' Humble Oil Co. Esmt.  
H.C.C.F. No. C274941  
Vol. 6297, Pg. 468 H.C.D.R.

65' Humble Oil Co. Esmt.  
H.C.C.F. No. C304498  
Vol. 6358, Pg. 599 H.C.D.R.

**MOORE CREEK  
(50' R.O.W.)**

150' Wide H.C.C.F.D. R.O.W. Esmt.  
Colled 5.840 Acres  
H.C.C.F. No. K140409

**BLOCK - ONE  
RESTRICTED RESERVE "A"  
(RESTRICTED TO CHURCH SITE)  
HOUSTON NORTHWEST BAPTIST CHURCH  
FILM CODE NO. 449016 H.C.M.R.**

**VILLAGES OF CYPRESS CREEK  
FILM CODE NO. 516062 H.C.M.R.**

**VILLAGES OF CYPRESS CREEK  
FILM CODE NO. 516062 H.C.M.R.**

**LEGEND**

- Concrete
- Asphalt
- Covered

mn = minor meter  
 mh = major meter  
 ip = right pole  
 bp = back of curb  
 pp = power pole  
 rec = record callout  
 BL = building line  
 DE = aerial easement  
 A.E. = aerial easement  
 H.C.D.R. = Harris County Deeds Record  
 H.C.M.R. = Harris County Maps Records

LINE	BEARING	DISTANCE	RECORD	BEARING	DISTANCE
1	S 88°37'08" W	1480.85'			
2	S 88°37'08" W	1480.85'			
3	S 88°37'08" W	1480.85'			
4	S 88°37'08" W	1480.85'			
5	S 88°37'08" W	1480.85'			
6	S 88°37'08" W	1480.85'			
7	S 88°37'08" W	1480.85'			
8	S 88°37'08" W	1480.85'			
9	S 88°37'08" W	1480.85'			
10	S 88°37'08" W	1480.85'			
11	S 88°37'08" W	1480.85'			
12	S 88°37'08" W	1480.85'			
13	S 88°37'08" W	1480.85'			
14	S 88°37'08" W	1480.85'			
15	S 88°37'08" W	1480.85'			
16	S 88°37'08" W	1480.85'			
17	S 88°37'08" W	1480.85'			
18	S 88°37'08" W	1480.85'			
19	S 88°37'08" W	1480.85'			
20	S 88°37'08" W	1480.85'			
21	S 88°37'08" W	1480.85'			
22	S 88°37'08" W	1480.85'			
23	S 88°37'08" W	1480.85'			
24	S 88°37'08" W	1480.85'			
25	S 88°37'08" W	1480.85'			
26	S 88°37'08" W	1480.85'			
27	S 88°37'08" W	1480.85'			
28	S 88°37'08" W	1480.85'			
29	S 88°37'08" W	1480.85'			
30	S 88°37'08" W	1480.85'			
31	S 88°37'08" W	1480.85'			
32	S 88°37'08" W	1480.85'			
33	S 88°37'08" W	1480.85'			
34	S 88°37'08" W	1480.85'			
35	S 88°37'08" W	1480.85'			
36	S 88°37'08" W	1480.85'			
37	S 88°37'08" W	1480.85'			
38	S 88°37'08" W	1480.85'			
39	S 88°37'08" W	1480.85'			
40	S 88°37'08" W	1480.85'			
41	S 88°37'08" W	1480.85'			
42	S 88°37'08" W	1480.85'			
43	S 88°37'08" W	1480.85'			
44	S 88°37'08" W	1480.85'			
45	S 88°37'08" W	1480.85'			
46	S 88°37'08" W	1480.85'			
47	S 88°37'08" W	1480.85'			
48	S 88°37'08" W	1480.85'			
49	S 88°37'08" W	1480.85'			
50	S 88°37'08" W	1480.85'			
51	S 88°37'08" W	1480.85'			
52	S 88°37'08" W	1480.85'			
53	S 88°37'08" W	1480.85'			
54	S 88°37'08" W	1480.85'			
55	S 88°37'08" W	1480.85'			
56	S 88°37'08" W	1480.85'			
57	S 88°37'08" W	1480.85'			
58	S 88°37'08" W	1480.85'			
59	S 88°37'08" W	1480.85'			
60	S 88°37'08" W	1480.85'			
61	S 88°37'08" W	1480.85'			
62	S 88°37'08" W	1480.85'			
63	S 88°37'08" W	1480.85'			
64	S 88°37'08" W	1480.85'			
65	S 88°37'08" W	1480.85'			
66	S 88°37'08" W	1480.85'			
67	S 88°37'08" W	1480.85'			
68	S 88°37'08" W	1480.85'			
69	S 88°37'08" W	1480.85'			
70	S 88°37'08" W	1480.85'			
71	S 88°37'08" W	1480.85'			
72	S 88°37'08" W	1480.85'			
73	S 88°37'08" W	1480.85'			
74	S 88°37'08" W	1480.85'			
75	S 88°37'08" W	1480.85'			
76	S 88°37'08" W	1480.85'			
77	S 88°37'08" W	1480.85'			
78	S 88°37'08" W	1480.85'			
79	S 88°37'08" W	1480.85'			
80	S 88°37'08" W	1480.85'			
81	S 88°37'08" W	1480.85'			
82	S 88°37'08" W	1480.85'			
83	S 88°37'08" W	1480.85'			
84	S 88°37'08" W	1480.85'			
85	S 88°37'08" W	1480.85'			
86	S 88°37'08" W	1480.85'			
87	S 88°37'08" W	1480.85'			
88	S 88°37'08" W	1480.85'			
89	S 88°37'08" W	1480.85'			
90	S 88°37'08" W	1480.85'			
91	S 88°37'08" W	1480.85'			
92	S 88°37'08" W	1480.85'			
93	S 88°37'08" W	1480.85'			
94	S 88°37'08" W	1480.85'			
95	S 88°37'08" W	1480.85'			
96	S 88°37'08" W	1480.85'			
97	S 88°37'08" W	1480.85'			
98	S 88°37'08" W	1480.85'			
99	S 88°37'08" W	1480.85'			
100	S 88°37'08" W	1480.85'			

**HOUSTON NORTHWEST BAPTIST CHURCH  
RESTRICTED TO CHURCH SITE  
FILM CODE NO. 449016 H.C.M.R.**

**VILLAGES OF CYPRESS CREEK  
FILM CODE NO. 516062 H.C.M.R.**

Rec: N 89°59'47" E - 72.05'  
N 89°59'47" E - 72.19'  
Concrete  
Paving Lot - 156.49'  
N 00°09'45" W - 584.68' (total)

**MANDOLIN DRIVE**  
(60' R.O.W.)

**MANDOLIN BLVD**  
(80' R.O.W.)

**BLOCK - FOUR  
RESTRICTED RESERVE "D"**

**BLOCK - THREE  
RESTRICTED RESERVE "C"**

**BLOCK - TWO  
RESTRICTED RESERVE "B"**

**BOUNDARY & IMPROVEMENT SURVEY  
MANOLIN DRIVE  
HOUSTON, TEXAS 77070**

Being all of Reserve "A", Block 1, of Houston Northwest Baptist Church, and being situated in the Abraham Lewis Acreage No. 833 according to the map or plat thereof, recorded under Film Code No. 449016 of the Map Records of that same district called 0.7538 acre tract as described in instrument to the Houston Northwest Baptist Church, recorded under File No. 05316536 of the Harris County Official Public Records of said Precinct.

**General Notes:**

- 1) The surveyor has not abstracted the subject property.
- 2) This survey is based on the information provided by the client and without the benefit of a current title report.
- 3) Additional building lines, easements, deed restrictions and other matters are shown as furnished by the client.
- 4) The surveyor does not certify to easements not shown hereon.
- 5) The bases for bearings for this survey, is based on the true meridian.
- 6) Controlling monuments for this survey are a 5/8" iron rod found marking the southwest corner of the subject property, through a 3/8" iron rod found marking the westerly most northwest corner of the subject property.

**1 hereby certify that this survey was made by me or under my direct supervision and that I am a duly Licensed Professional Land Surveyor in the State of Texas.**

Date of Survey: February 26, 2016 US

ZACHARAH R. SWOREY  
REGISTERED PROFESSIONAL LAND SURVEYOR  
NO. 59666

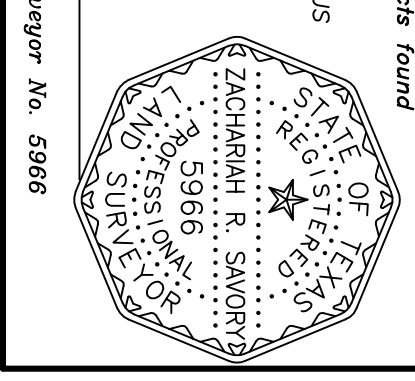

Subject acreage shown herein is located in Zone X, Shaded Zone X and Zone AE (having a BEFS1217), and a portion does appear to lie within the 100-year flood plain, according to the FEMA Flood Insurance Rate Map, Community Panel 48201C (information is based on a hydrologic plotting only. Surveyor assumes no responsibility for exact determination).

PROJECT NO. 199-08  
KEY MAP  
REVISIONS: MAM  
DRAWN BY: MAM